

Maple Ridge of
**TERRYBROOK
 FARMS**

A Julian • Rodrock Homes Community

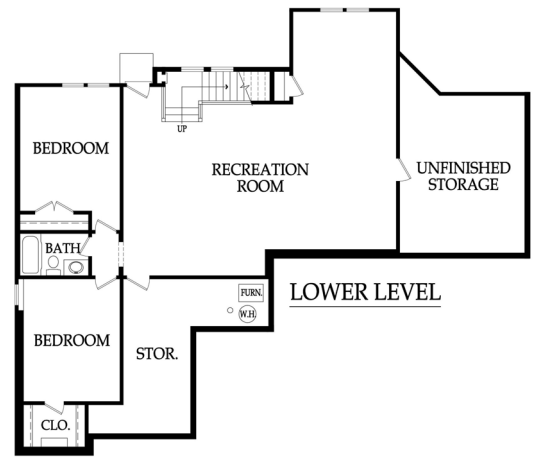

The Hampton V
 by New Mark Homes

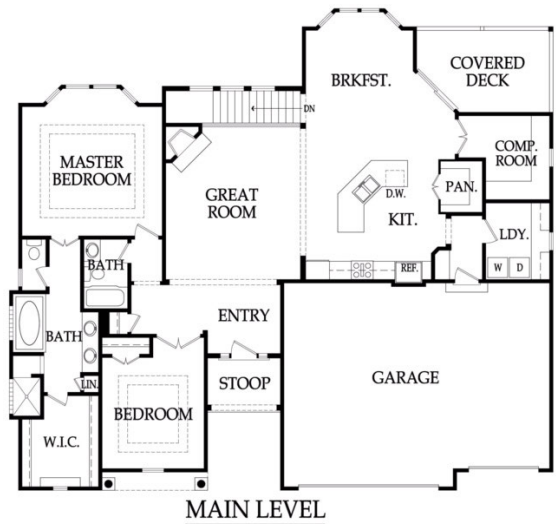

Details
 Rev 1.5 Story
 3,302 sqft.
 4 bedrooms
 3 baths

Artist rendering may differ from actual plans. Base price does not include price of homesite, city, or subdivision requirements. Square footage is estimated.