

Gripper ribs 120 deg.
around circumference

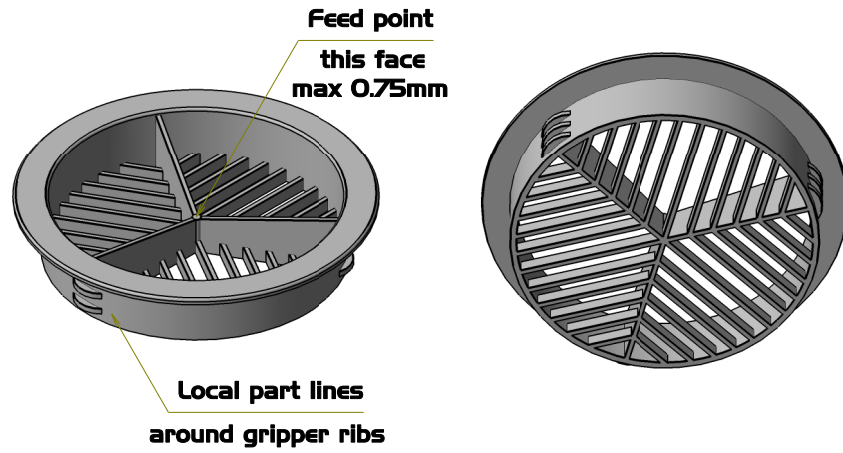
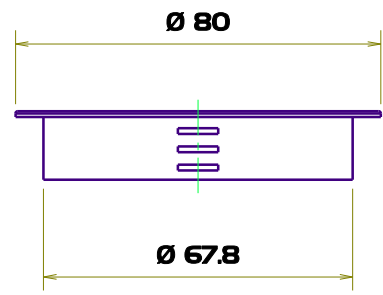

Local part lines
around gripper ribs

File location: CAD files on PlasmotecOI/ Original/ Plasmotec / PLAI239A - 70mm HI-flo Soffit Vent

"This drawing represents our interpretation of your instructions and all sizes and tolerances should be carefully checked. We assume that the profile is an original design owned by you, and we shall, accordingly produce it in good faith. Should the profile infringe any patent, registered design or copyright owned by a third party, we shall assume that we are indemnified by you against all loss we may suffer arising from any claims by that third party. Your signature indicates acceptance of the drawing, and that our assumption is correct"

All dimensions in millimeters
Tolerance unless stated to be the larger of:
whole numbers (0) +/- 0.5 or 0.5%
one decimal place (0.0) +/- 0.25 or 0.25%
two decimal places (0.00) +/- 0.12 or 0.12%

PLASMOTEC LTD

TITLE 70mm HI-flo Soffit Vent

Generic Matl. Polypropylene

Drwn By Andy

Ch'd by

ISS Original **DATE** 03/12/14

REVISIONS

DATE 03/12/14 **DRG.No** PLAI239A

FINISH PSF08 Std Machined