

Piston seals

Seal housing

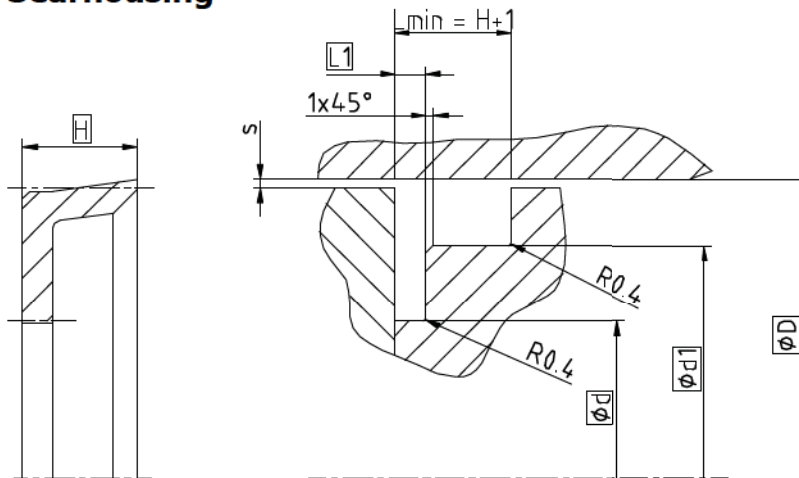

Surface roughness	Rtmax	Ra
Sliding Surface	≤ 2,5 µm	0,1...0,5 µm
Bottom of groove	≤ 6,3 µm	≤ 1,6 µm
Groove face	≤ 15 µm	≤ 3 µm

Ordering dimensions...□

Bearing area: 50...95% and a cutting depth of 0,5xRz based on Cref = 0%

Standard dimensions

This is not a standard profile and serves as a replacement for an existing housing. New constructions should use standard profiles.

Operating parameters

Sealing material	Temperature	max. speed		max. pressure	
		linear	rotary	linear ¹	rotary
ECOPUR®	-30 °C...+110 °C	0,5 m/s	2 m/s	160 bar (16 MPa)	7 bar (0,7 MPa)
H-ECOPUR™	-20 °C...+110 °C				
S-ECOPUR™	-20 °C...+110 °C				
T-ECOPUR™	-50 °C...+110 °C				
G-ECOPUR™	-30 °C...+110 °C	0,5 m/s			
SKF ECORUBBER-1	-30 °C...+100 °C	0,5 m/s	5 m/s	160 bar (16 MPa)	5 bar (0,5 MPa)
SKF ECORUBBER-2	-20 °C...+200 °C				
SKF ECORUBBER-3	-50 °C...+150 °C				
SKF ECORUBBER-H	-25 °C...+150 °C				
SKF ECOFLAS	-10 °C...+200 °C				

The stated operation conditions represent general indications. It is recommended not to use all maximum values simultaneously. Surface speed limits apply only to the presence of adequate lubrication film.

¹ Pressure ratings depend on the size of the extrusion gap.

Ordering example

K16-A, D=58mm, d=50mm, d1=53mm, L1=3mm, H=12mm, ECOPUR®

Piston Seal K16-A
Profile

58 x 50/53 x 3/12
D x d/d1 x L1/H

ECOPUR®
Sealing material