

### Seal housing

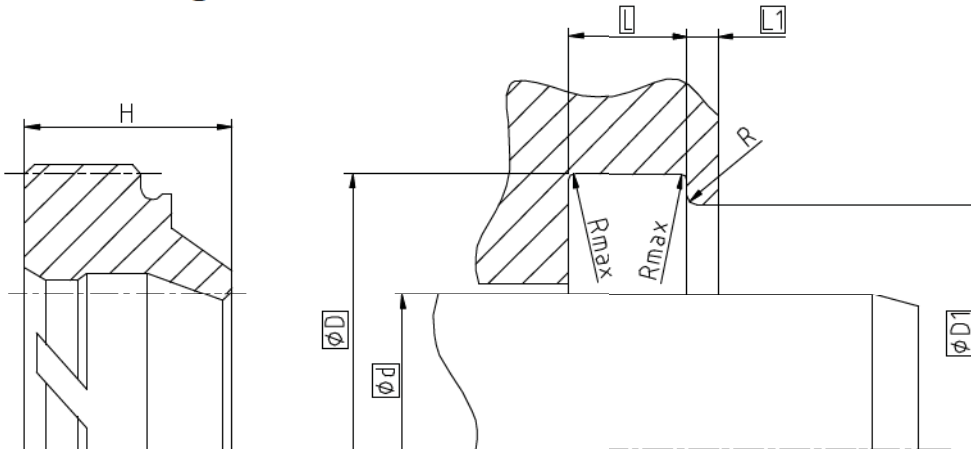

| Surface roughness | Rtmax    | Ra           |
|-------------------|----------|--------------|
| Sliding Surface   | ≤ 2,5 µm | 0,1...0,5 µm |
| Bottom of groove  | ≤ 6,3 µm | ≤ 1,6 µm     |
| Groove face       | ≤ 15 µm  | ≤ 3 µm       |

Ordering dimensions...□

Bearing area: 50...95% and a cutting depth of 0,5xRz based on Cref = 0%

### Standard dimensions

| Ød f8           | ØD H11 | ØD1 H11 | L +0,2 | L1  | Rmax | R     | H  |
|-----------------|--------|---------|--------|-----|------|-------|----|
| ≥ 11 ... ≤ 100  | d + 8  | d + 6   | 4      | 1   | 0,4  | ≤ 0,4 | 7  |
| > 100 ... < 150 | d + 12 | d + 9   | 5,5    | 1,5 |      |       | 10 |
| ≥ 150           | d + 15 | d + 11  | 6,5    | 2   |      |       | 13 |

### Operating parameters

| Sealing material | Temperature             | max. speed   |
|------------------|-------------------------|--------------|
| <b>ECOPUR®</b>   | <b>-30 °C...+110 °C</b> | <b>4 m/s</b> |
| H-ECOPUR™        | -20 °C...+110 °C        |              |
| S-ECOPUR™        | -20 °C...+110 °C        | 5 m/s        |
| T-ECOPUR™        | -50 °C...+110 °C        | 4 m/s        |
| G-ECOPUR™        | -30 °C...+110 °C        |              |
| X-ECOPUR™        | -30 °C...+110 °C        | 4 m/s        |
| XH-ECOPUR™       | -20 °C...+110 °C        |              |
| XS-ECOPUR™       | -20 °C...+110 °C        | 5 m/s        |
| G-ECOPUR 54D™    | -30 °C...+110 °C        | 4 m/s        |
| SKF ECORUBBER-1  | -30 °C...+100 °C        | 4 m/s        |
| SKF ECORUBBER-2  | -20 °C...+200 °C        |              |
| SKF ECORUBBER-3  | -50 °C...+150 °C        |              |
| SKF ECORUBBER-H  | -25 °C...+150 °C        |              |
| SKF ECOFLAS      | -10 °C...+200 °C        |              |
|                  |                         |              |

The stated operation conditions represent general indications. It is recommended not to use all maximum values simultaneously. Surface speed limits apply only to the presence of adequate lubrication film.

### Ordering example

A01-A, d=50mm, D=58mm, D1=56mm, L=4mm, L1=1mm, ECOPUR®

**Wiper A01-A**  
Profile

**50 x 58/56 x 4/1**  
d x D/D1 x L/L1

**ECOPUR®**  
Sealing material