

Seal housing

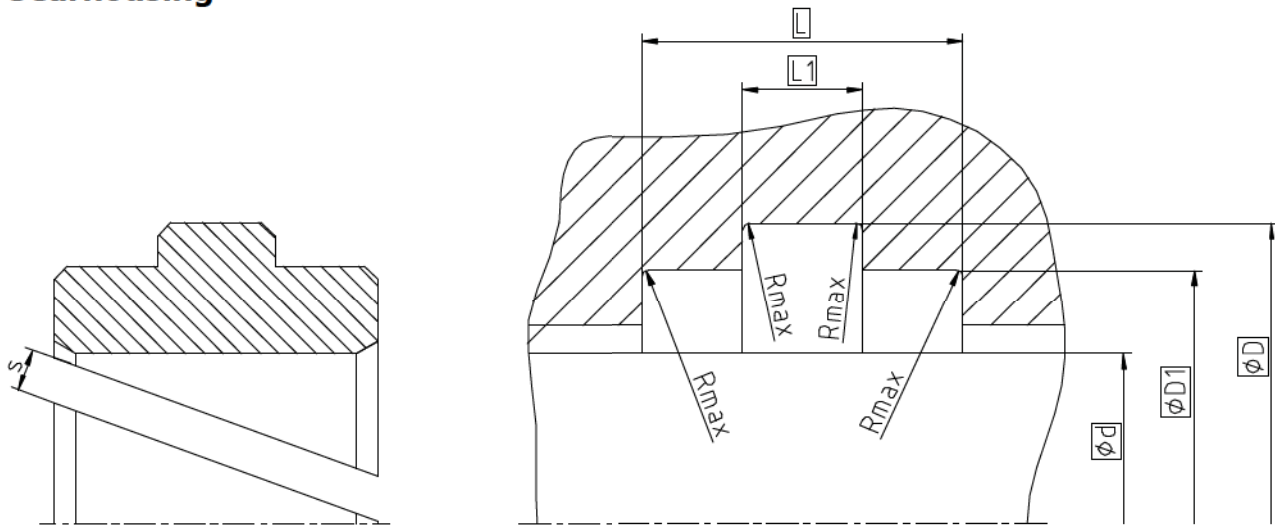

Sealing material	PU/Elastomers		PTFE	
	Rtmax	Ra	Rtmax	Ra
Sliding Surface	≤ 2,5 µm	0,1...0,5 µm	≤ 2 µm	0,05...0,3 µm
Bottom of groove	≤ 6,3 µm	≤ 1,6 µm	≤ 6,3 µm	≤ 1,6 µm
Groove face	≤ 15 µm	≤ 3 µm	≤ 15 µm	≤ 3 µm

Ordering dimensions...

Bearing area: 50...95% and a cutting depth of 0,5xRz based on Cref = 0%

Standard dimensions

Ød f8	ØD H10	ØD1 H8	ØD2	L +0,2	L1 +0,2
≥ 5 ... ≤ 36	d + 6	d + 2,8	d + 0,35	8,5	3
> 36 ... ≤ 60	d + 7,5	d + 3,2	d + 0,4	10,5	3,5
> 60 ... ≤ 90	d + 9	d + 3,5	d + 0,5	15	5
> 90 ... ≤ 150			d + 0,6		
> 150 ... ≤ 200	d + 16	d + 7,1	d + 0,7	20,3	8
> 200	d + 17	d + 7,5	d + 0,8	25	

* cutting gap s : values depend on material and temperature. For detailed information please refer to the profile description.

Operating parameters

Guiding material	Temperature	max. speed	Specific load ²
SKF ECOFLON 2	-200 °C...+200 °C	4 m/s	3,0 N/mm ²
SKF ECOFLON 3	-200 °C...+200 °C	5 m/s	4,5 N/mm ²
SKF ECOFLON 60% Bz.	-200 °C...+200 °C	5 m/s	7,5 N/mm ²
SKF ECOTAL	-50 °C...+100 °C	4 m/s	25 N/mm²
SKF ECOMID	-40 °C...+100 °C	4 m/s	25 N/mm ²
SKF ECOTEX	-40 °C...+130 °C	4 m/s	90 N/mm ²

The stated operation conditions represent general indications. It is recommended not to use all maximum values simultaneously. Surface speed limits apply only to the presence of adequate lubrication film.

¹ ≤ Ø260mm: SKF ECOTAL ; > Ø260mm: SKF ECOMID

² Depending on temperature and allowed compression. Detailed information see profile description.

Ordering example

F06, d=100mm, D=109mm, D1=103,5, L=15mm, L1=5mm, SKF ECOTAL

Guide Ring F06
Profile

100 x 109/103,5 x 15/5
d x D/D1 x L/L1

SKF ECOTAL
Guiding material