

Seal housing

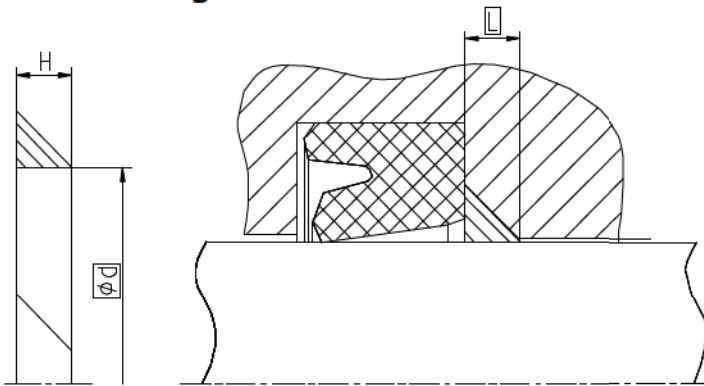

Sealing material	PU/Elastomers		PTFE	
	Rtmax	Ra	Rtmax	Ra
Sliding Surface	≤ 2,5 µm	0,1...0,5 µm	≤ 2 µm	0,05...0,3 µm
Bottom of groove	≤ 6,3 µm	≤ 1,6 µm	≤ 6,3 µm	≤ 1,6 µm
Groove face	≤ 15 µm	≤ 3 µm	≤ 15 µm	≤ 3 µm

Ordering dimensions...□

Bearing area: 50...95% and a cutting depth of 0,5xRz based on Cref = 0%

Standard dimensions

minimum nominal inside diameter $\varnothing d \geq 4,5\text{mm}$

Profile size, surface data and tolerances are the result of a combination of the relevant application specific sealing material. Standard version: incision gap 0. cut 45°

Operating parameters

Backup material	Temperature
SKF ECOTAL	-50 °C...+100 °C
SKF ECOFLON 2	-200 °C...+260 °C
SKF ECOMID	-40 °C...+100 °C
SKF ECOPAEK	-60 °C...+260 °C

The stated operation conditions represent general indications. It is recommended not to use all maximum values simultaneously. Surface speed limits apply only to the presence of adequate lubrication film.

Ordering example

ST12, d=100mm, L=13mm, SKF ECOTAL

Backup ring ST12
Profile

100 x 13
d x L

SKF ECOTAL
Backup ring