



*we*innovate cooking

KITCHENS DIAMANTE 90

BOILING PANS

Model

D93/10PGD05

Code

CR0991049

General characteristics

Stainless steel outer coatings and feet.
Worktops made of 2 mm thick, brushed AISI 304 stainless steel.
Adjustable worktop height from 840 to 900 mm.
Contoured control panels with controls tilted towards the operator.
Large knobs that do not protrude from the machine structure.
Range modularity: 200-400-600-800-1200.
Simple and effective coupling system.
Appliances set up for the plinth.
Vast accessory range.
Appliances in compliance with CE standards.

GAS BOILING PAN 50 LT. DIRECT HEATING



Technical/functional characteristics

Outer casing and feet in stainless steel. Adjustable worktop height, ranging from 840 to 900 mm. Adjustable worktop height, ranging from 840 to 900 mm. AISI 304 stainless steel pan with base in AISI 316 stainless steel. Water loading using the tap and both hot or cold water may be loaded. Front discharge with 2-inch chrome brass taps. Gas model: 2 AISI 304 stainless steel burners positioned on the base of the appliance (for direct heating operations) or in the cavity (for indirect heating operations).

Technical Data

Model	D93/10PGD05
Width (mm)	600,00
Depth (mm)	900,00
Height (mm)	870,00
VOLUME	1,10
WEIGHT	116,00
SUPPLY	GAS-EL
Gas power	10.5
Electric power	0.2
Internal ovens dimension	
OVEN CAPACITY	
Plate dimensions (mm)	
TANK DIMENSIONS	Ø=400
Tank capacity (l)	50Lt.

BOILING PANS

Model

D93/10PGD05

Code

CR0991049

D93/10 PGD05

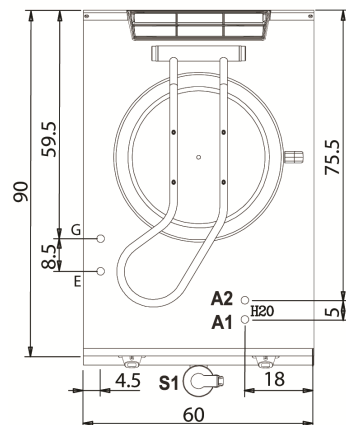
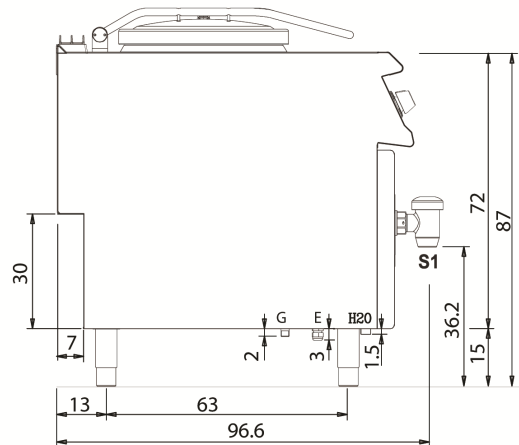
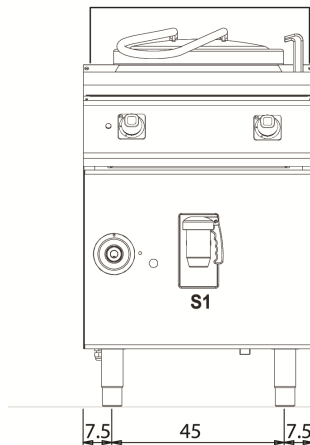

KEY

- E** power supply
- G** gas connection
- H2O** water inlet
- S** water outlet

Supply

Gas connection	10.5	1/2"	
Electric connection	0.2	230	
Cold water connection		3/4"	0
Hot water connection		3/4"	
Cold soft water connection			
Drain (Ø)		1 1/2"	
2° Drain (Ø)			