



*we*innovate cooking

KITCHENS DIAMANTE 70

GAS SOLID TOP RANGES

Model

D74/10CTGG

Code

CR0993669

General characteristics

Stainless steel outer coatings and feet.
Worktops made of 1,5 mm thick, brushed AISI 304 stainless steel.
Adjustable worktop height from 840 to 900 mm.
Contoured control panels with controls tilted towards the operator.
Large knobs that do not protrude from the machine structure.
Range modularity: 200-400-600-800-1200.
Simple and effective coupling system.
Appliances set up for the plinth.
Vast accessory range.
Appliances in compliance with CE standards.

GAS SOLID TOP ON GAS OVEN



Technical/functional characteristics

Outer casing and feet in stainless steel.
Adjustable worktop height, ranging from 840 to 900 mm.
Plate and central rings in cast iron.
Steel burner controlled by thermocouple safety valve.
Piezo electric lighter. Plate temperature regulation, ranging from 50° to 450°C.
Thermocouple safety valve with pilot light. Open flame model: 3.5 and 5 kW burners.
Gas oven heating with stainless steel burner with self-stabilizing flame, and thermostatically-controlled temperature range from 100 to 300°C.

Technical Data

Model	D74/10CTGG
Width (mm)	800,00
Depth (mm)	730,00
Height (mm)	870,00
VOLUME	0,80
WEIGHT	125,00
SUPPLY	
Gas power	20
Electric power	
Internal ovens dimension	
OVEN CAPACITY	
Plate dimensions (mm)	
TANK DIMENSIONS	
Tank capacity (l)	

GAS SOLID TOP RANGES

Model

D74/10CTGG

Code

CR0993669

D74/10 CTGG

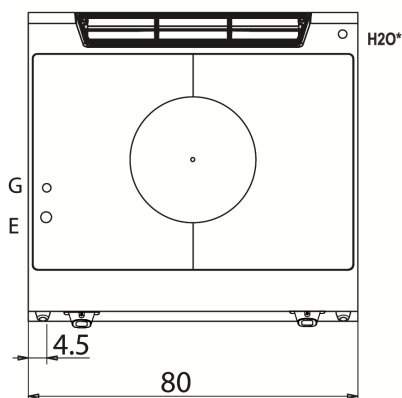
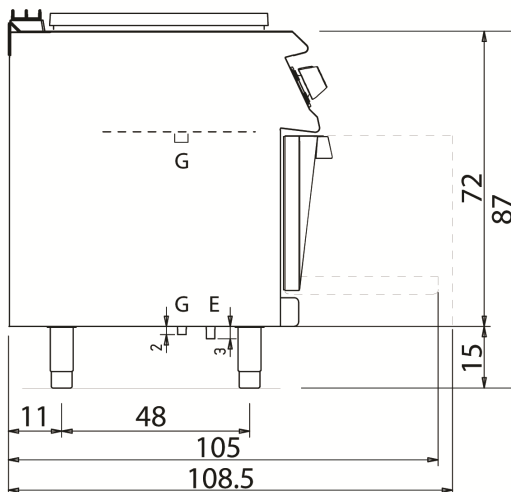
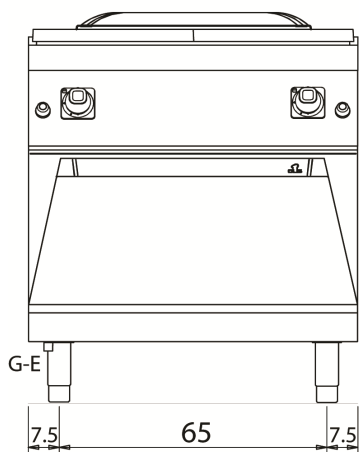

KEY

E power supply

G gas connection

H2O water inlet

S water outlet

Connection	Power	Diameter	Supply
Gas connection	20	1/2"	
Electric connection			
Cold water connection			
Hot water connection			
Cold soft water connection			
Drain (Ø)			
2° Drain (Ø)			