

Other models in this range:
MV306 - MV456 - MV806
MV1006

MV Cube Ice Machines up to 320 Kg



MV 606 with B393 (sold separately)

Standard Features

- **"Global Standard" width-** 30" (76.20 cm) wide
- **Auto-Alert indicator lights-** communicate about operating status: a diagnostic LED light guides the troubleshooting process and helps decisions regarding opening a service call.
- **Front-facing Evaporator-** Ice forming process inspection and routine cleaning operations may be accomplished simply removing the front panel.
- **Hand-removable water distribution tube-** routine cleaning has never been so easy!
- **Embedded antimicrobial-** Ag-Ion® antimicrobial is present in selected food-zone components
- **External Components-** All external panel components are crafted for optimal aesthetic appeal through superior fit and finish
- **Reusable air filter** is easily removable from the outside for ease of cleaning (in air-cooled models)
- **California Energy Commission-** meets or exceeds CEC guidelines

MV606 Technologies

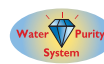

MV606+B393
(sold separately)



MV606+B530
(sold separately)

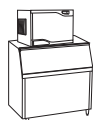

MV606+B948+KBTMVB948
(sold separately)



MV606+B1025
(sold separately)

		24h						
		21°: 10°C	32°: 21°C					
		[kg]	[lbs]	N°	N°	[WxDxH mm]		
MV606 AS		290	639	29000	215	474	21500	760x620x575
MV606 WS		275	606	27500	240	529	24000	[WxDxH inches]
MVH606 AS		290	639	48140	215	474	35690	2915/16"x 247/16"x 2210/16"
MVH606 WS		275	606	45650	240	529	39840	
								[v/Hz/ph] 220-240/50/1 R 404 a

This product qualifies for the following listings:



Dice Cube - 10 g
23 x 23 x 26 mm



Half Dice Cube - 6 g
11 x 23 x 26 mm

2 Years Warranty

Subject to certain limitations and exclusions

Certified ISO 9001:2000

www.scotsman-ice.com
www.scotsman-ice.it

Models and specifications are subject to change without notice.

MV Cube Ice Machines up to 320 Kg

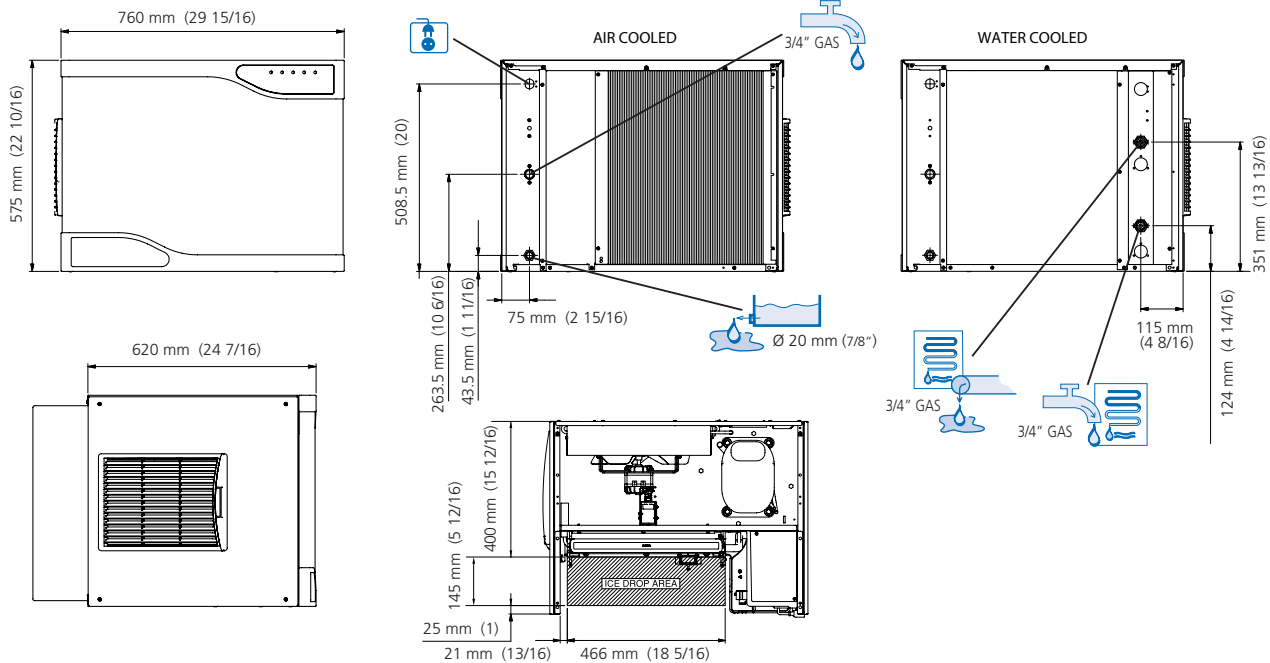

MV606 AIR COOLED

°C	°F				kg
	50°	60°	70°	90°	
10°	320	305	285	250	kg
50°	705	672	628	551	lbs
21°	290	280	265	235	kg
70°	639	617	584	518	lbs
32°	225	220	215	195	kg
90°	496	485	474	430	lbs
38°	192	189	185	175	kg
100	423	417	408	386	lbs



MV606 WATER COOLED

°C	°F				kg
	50°	60°	70°	90°	
10°	285	280	275	253	kg
50°	628	617	606	558	lbs
21°	275	270	265	245	kg
70°	606	595	584	540	lbs
32°	250	245	240	220	kg
90°	551	540	529	485	lbs
38°	245	240	235	215	kg
100	540	529	518	474	lbs



Minimum	Maximum
10°C (50°F)	40°C (104°F)
5°C (41°F)	35°C (95°F)
-10%	+10%
1 BAR 14 psi	5 BAR 70 psi

	Compressor	Capacity [Btu/h] [W]	Condenser [Ømm²]	Power [W]	FUSE	Energy [kWh] - 100 Kg	Water [l/h]	Ice [kg] [lbs]	Weight [kg] [lbs]
MV606 AS	Compressor	13150 3860	3x1,5	1300	16 A	13	14,5 3,8	71 157	86 190
MV606 WS	Water Cooled	13150 3860	3x1,5	1050	16 A	9,6	137 36,2	71 157	86 190
MVH606 AS	Compressor	13150 3860	3x1,5	1300	16 A	13	14,5 3,8	71 157	86 190
MVH606 WS	Water Cooled	13150 3860	3x1,5	1050	16 A	9,6	137 36,2	71 157	86 190

CONTACT POINTS:

Europe
Scotsman Europe-Frimont S.p.A.
Via Puccini, 22
20010 Pogliano (Milano) Italy
Ph: (+39) 02-93960208
Fax: (+39) 02-93960201
scotsman.europe@frimont.it

Asia and Pacific
Scotsman Ice Systems-Frimont S.p.A. (R.O.)
627A Aljunied Road-#04-04 Biztech Centre
Singapore 389842
Ph: (+65) 6738 5393
Fax: (+65) 6738 1959
scotsice@singnet.com.sg

China
Scotsman Ice Systems (Shanghai)
Room 2503, Building 2
20 Xuhong Middle Road, Xuhui District
Shanghai China 200235
Main line: (+86) 21 61313200
Fax: (+86) 21 61313330
scotsman.shanghai@scotsman-china.com

Middle East & N. Africa
Scotsman Ice Systems Dubai Office
Po. Box 21648
Sharjah - U.A.E.
Ph: (+97) 16-5773-164
Fax (+97) 16-5773-165
scotsman@eim.ae

South Africa
Scotsman Ice Systems SA (PTY) Ltd.
10, Rhodes Street - Kensington B
Po. Box 44 - Riverclub 2149
Ph: (+27) 11-7898400
Fax (+27) 11-7898411
scotsman@telkomsa.net

Spain
Scotsman España, S.L.U. c/ Galapagar, 12
Poligono Industrial Ventorro del Cano
28925 Alcorcon (Madrid)
Ph: +34-91-1109796
Fax: +34-91-6337423
E-mail: scotsman@scotsman-espana.es
www.scotsman-espana.es