



*we*innovate cooking

# KITCHENS DIAMANTE 90

## GAS SOLID TOP RANGES

Model

D94/10CTGG

Code

CR0995589

### General characteristics

- Stainless steel outer coatings and feet.
- Worktops made of 2 mm thick, brushed AISI 304 stainless steel.
- Adjustable worktop height from 840 to 900 mm.
- Contoured control panels with controls tilted towards the operator.
- Large knobs that do not protrude from the machine structure.
- Range modularity: 200-400-600-800-1200.
- Simple and effective coupling system.
- Appliances set up for the plinth.
- Vast accessory range.
- Appliances in compliance with CE standards.

## GAS SOLID TOP ON GAS OVEN



### Technical/functional characteristics

- Outer casing and feet in stainless steel.
- Adjustable worktop height, ranging from 840 to 900 mm.
- Plate and central rings in cast iron.
- Steel burner controlled by thermocouple safety valve.
- Piezo electric lighter. Plate temperature regulation, ranging from 50° to 450°C.
- Thermocouple safety valve with pilot light. Open flame model: 3.5 and 5 kW burners.
- Gas oven heating with stainless steel burner with self-stabilizing flame, and thermostatically-controlled temperature range from 100 to 300°C.

### Technical Data

|                          |              |
|--------------------------|--------------|
| Model                    | D94/10CTGG   |
| Width (mm)               | 800,00       |
| Depth (mm)               | 900,00       |
| Height (mm)              | 870,00       |
| VOLUME                   | 1,10         |
| WEIGHT                   | 230,00       |
| SUPPLY                   | GAS          |
| Gas power                | 22           |
| Electric power           |              |
| Internal ovens dimension | 575x700x300h |
| OVEN CAPACITY            | GN2/1        |
| Plate dimensions (mm)    |              |
| TANK DIMENSIONS          |              |
| Tank capacity (l)        |              |

### GAS SOLID TOP RANGES

Model  
D94/10CTGG

Code  
CR0995589

**D94/10 CTGG**

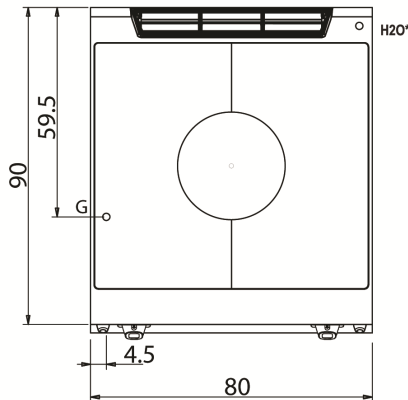
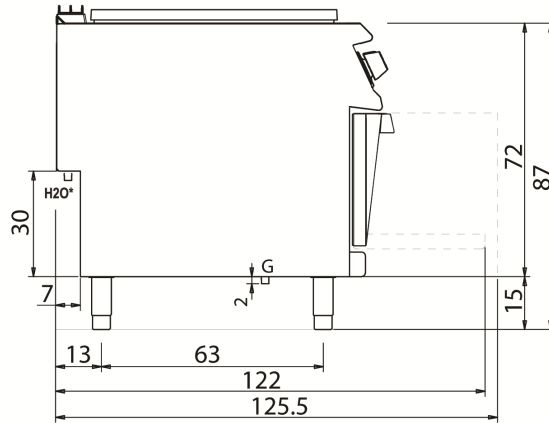
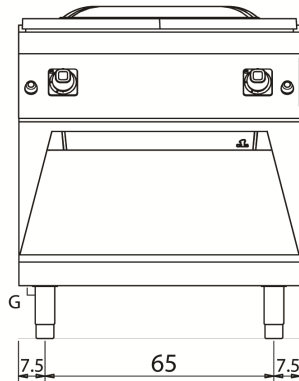

#### KEY

- E power supply
- G gas connection
- H2O water inlet
- S water outlet

| Connection                | Power | Diameter | Supply |
|---------------------------|-------|----------|--------|
| Gas connecton             | 22    | 1/2"     |        |
| Electric connecton        |       |          |        |
| Cold water connecton      |       |          |        |
| Hot water connecton       |       |          |        |
| Cold soft water connecton |       |          |        |
| Drain (∅)                 |       |          |        |
| 2° Drain (∅)              |       |          |        |