



*we*innovate cooking

# KITCHENS DIAMANTE 90

## GAS SOLID TOP RANGES

Model

D94/10TCTG

Code

CR0995489

### General characteristics

- Stainless steel outer coatings and feet.
- Worktops made of 2 mm thick, brushed AISI 304 stainless steel.
- Adjustable worktop height from 840 to 900 mm.
- Contoured control panels with controls tilted towards the operator.
- Large knobs that do not protrude from the machine structure.
- Range modularity: 200-400-600-800-1200.
- Simple and effective coupling system.
- Appliances set up for the plinth.
- Vast accessory range.
- Appliances in compliance with CE standards.

### GAS SOLID TOP



### Technical/functional characteristics

- Outer casing and feet in stainless steel. Adjustable worktop height, ranging from 840 to 900 mm. Plate and central rings in cast iron.
- Steel burner controlled by thermocouple safety valve. Piezo electric lighter. Plate temperature regulation, ranging from 50° to 450°C.
- Thermocouple safety valve with pilot light.

### Technical Data

Model	D94/10TCTG
Width (mm)	800,00
Depth (mm)	900,00
Height (mm)	280,00
VOLUME	0,40
WEIGHT	125,00
SUPPLY	GAS
Gas power	14
Electric power	
Internal ovens dimension	
OVEN CAPACITY	
Plate dimensions (mm)	
TANK DIMENSIONS	
Tank capacity (l)	

### GAS SOLID TOP RANGES

Model  
D94/10TCTG

Code  
CR0995489

#### D94/10 TCTG

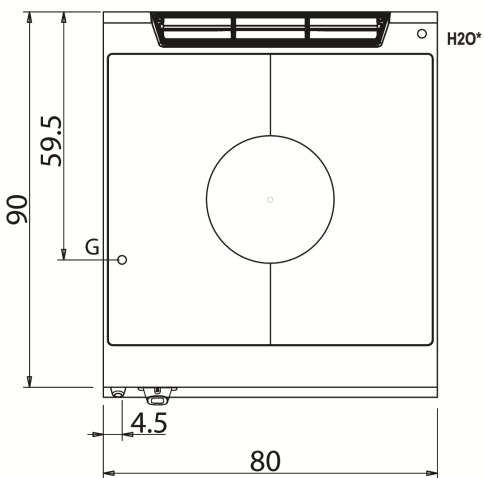
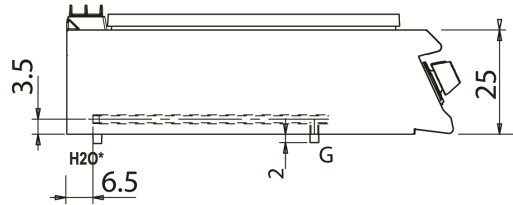
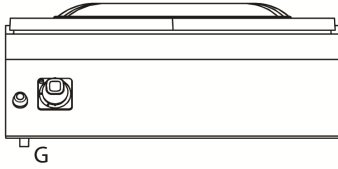

#### KEY

- E power supply
- G gas connection
- H2O water inlet
- S water outlet

Connection	Power	Diameter	Supply
Gas connecton	14	1/2"	
Electric connecton			
Cold water connecton			
Hot water connecton			
Cold soft water connecton			
Drain (Ø)			
2° Drain (Ø)			