



*we*innovate cooking

KITCHENS DIAMANTE 70

TILTING BRATT PANS

Model

D74/10KBGI

Code

CR0989969

General characteristics

- Stainless steel outer coatings and feet.
- Worktops made of 1,5 mm thick, brushed AISI 304 stainless steel.
- Adjustable worktop height from 840 to 900 mm.
- Contoured control panels with controls tilted towards the operator.
- Large knobs that do not protrude from the machine structure.
- Range modularity: 200-400-600-800-1200.
- Simple and effective coupling system.
- Appliances set up for the plinth.
- Vast accessory range.
- Appliances in compliance with CE standards.

GAS BRATT PAN WITH MANUAL TILTING 43LT.WITH BOTTOM MADE IN COMPOUND



Technical/functional characteristics

- Outer casing and feet in stainless steel.
- Adjustable worktop height, ranging from 840 to 900 mm.
- Strong double-walled self-balancing lid, 1,5 mm thick AISI 304 stainless steel cooking pot, with bottom made in compound
- Thermostatically-controlled cooking temperature range from 100 to 280°C.
- Chrome steel burner for cooking operations.
- Safety valve with thermocouple, electric ignition.
- Manual bowl lifting.

Technical Data

Model	D74/10KBGI
Width (mm)	800,00
Depth (mm)	730,00
Height (mm)	870,00
VOLUME	0,80
WEIGHT	135,00
SUPPLY	
Gas power	14
Electric power	0.2
Internal ovens dimension	
OVEN CAPACITY	
Plate dimensions (mm)	
TANK DIMENSIONS	
Tank capacity (l)	

TILTING BRATT PANS

Model
D74/10KBGI

Code
CR0989969

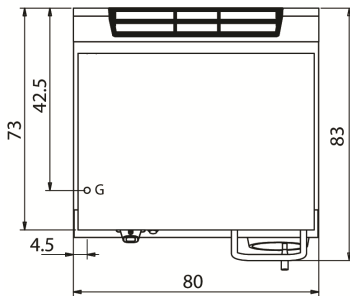
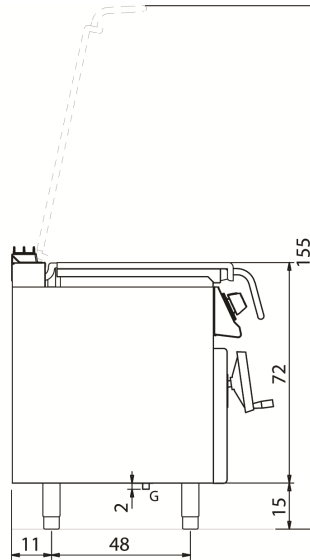
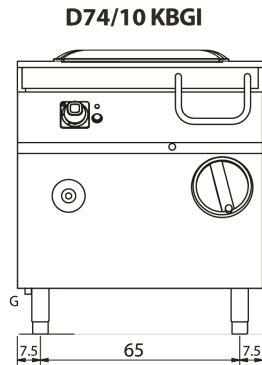

KEY

- E power supply
- G gas connection
- H2O water inlet
- S water outlet

Connection	Power	Diameter	Supply
Gas connecton	14	1/2"	
Electric connecton	0.2	230	
Cold water connecton			0
Hot water connecton			
Cold soft water connecton			
Drain (∅)			
2° Drain (∅)			