

### Seal housing

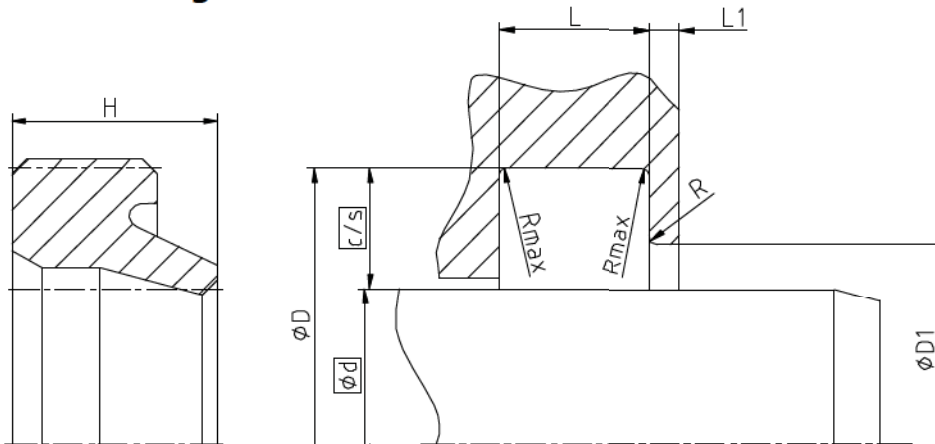

Surface roughness	Rtmax	Ra
Sliding Surface	≤ 2,5 µm	0,1...0,5 µm
Bottom of groove	≤ 6,3 µm	≤ 1,6 µm
Groove face	≤ 15 µm	≤ 3 µm

Ordering dimensions...

Bearing area: 50...95% and a cutting depth of 0,5xRz based on Cref = 0%

### Standard dimensions

Ød f8	c/s	ØD H11	ØD1 H11	L +0,2	L1	Rmax	R	H
≥ 5 ... ≤ 28	3	d + 6	d + 2,5	4	≥ 2	0,4	≤ 0,43	5,3
> 28 ... ≤ 56	4	d + 8	d + 3	5				7
> 56 ... ≤ 110	5	d + 10	d + 3	6				8
> 110	7,5	d + 15	d + 4	8,5				≤ 0,4

### Operating parameters

Sealing material	Temperature	max. speed
<b>ECOPUR®</b>	<b>-30 °C...+110 °C</b>	<b>4 m/s</b>
H-ECOPUR™	-20 °C...+110 °C	
S-ECOPUR™	-20 °C...+110 °C	5 m/s
T-ECOPUR™	-50 °C...+110 °C	4 m/s
G-ECOPUR™	-30 °C...+110 °C	
X-ECOPUR™	-30 °C...+110 °C	4 m/s
XH-ECOPUR™	-20 °C...+110 °C	
XS-ECOPUR™	-20 °C...+110 °C	5 m/s
G-ECOPUR 54D™	-30 °C...+110 °C	4 m/s
SKF ECORUBBER-1	-30 °C...+100 °C	4 m/s
SKF ECORUBBER-2	-20 °C...+200 °C	
SKF ECORUBBER-3	-50 °C...+150 °C	
SKF ECORUBBER-H	-25 °C...+150 °C	
SKF ECOFLAS	-10 °C...+200 °C	

The stated operation conditions represent general indications. It is recommended not to use all maximum values simultaneously. Surface speed limits apply only to the presence of adequate lubrication film.

### Ordering example

A02-I, d=50mm, c/s=4mm, ECOPUR®

**Wiper A02-I**  
Profile

**50 x 4**  
d x c/s

**ECOPUR®**  
Sealing material