

### Seal housing

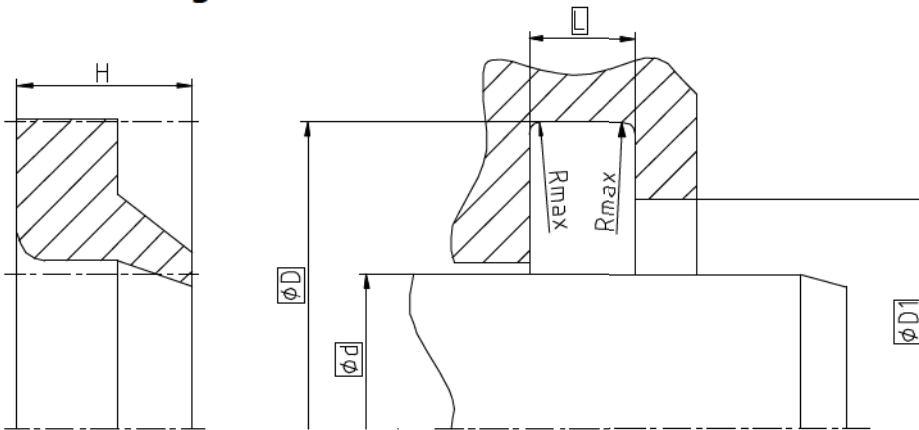

Surface roughness	Rtmax	Ra
Sliding Surface	≤ 2,5 µm	0,1...0,5 µm
Bottom of groove	≤ 6,3 µm	≤ 1,6 µm
Groove face	≤ 15 µm	≤ 3 µm

Ordering dimensions...□

Bearing area: 50...95% and a cutting depth of 0,5xRz based on Cref = 0%

### Standard dimensions

Ød f8		ØD H10	ØD1 H11	L +0,1	Rmax
≥ 5	≤ 65	d + 7	d + 4	2,7	0,4
≥ 65	... ≤ 100	d + 9,3	d + 5	3,1	0,4
≥ 100	... ≤ 140	d + 11	d + 6	3,5	0,4
≥ 140	... ≤ 280	d + 12,5	d + 7	3,9	0,4
≥ 280	... ≤ 600	d + 12,5	d + 7	4,3	0,4

### Operating parameters

Sealing material	Temperature	max. speed
<b>ECOPUR®</b>	<b>-30 °C...+110 °C</b>	<b>4 m/s</b>
H-ECOPUR™	-20 °C...+110 °C	
S-ECOPUR™	-20 °C...+110 °C	5 m/s
T-ECOPUR™	-50 °C...+110 °C	4 m/s
X-ECOPUR™	-30 °C...+110 °C	4 m/s
XH-ECOPUR™	-20 °C...+110 °C	
XS-ECOPUR™	-20 °C...+110 °C	5 m/s
SKF ECORUBBER-1	-30 °C...+100 °C	4 m/s
SKF ECORUBBER-2	-20 °C...+200 °C	
SKF ECORUBBER-3	-50 °C...+150 °C	
SKF ECORUBBER-H	-25 °C...+150 °C	
SKF ECOFLAS	-10 °C...+200 °C	

The stated operation conditions represent general indications. It is recommended not to use all maximum values simultaneously. Surface speed limits apply only to the presence of adequate lubrication film.

### Ordering example

A09-A, d=70mm, D=79,3mm, D1=75mm, L=3,1mm ECOPUR®

**Wiper A09-A**  
Profile

**70 x 79,3/75 x 3,1**  
d x D/D1 x L

**ECOPUR®**  
Sealing material