

TTNC-102-2, 101-4, 151-2, 201-2

MULTI-SPINDLE FOR HIGH PRODUCTION

Multiple spindle tilting rotary tables for high production 4th & 5th axis machining. These tables are suitable for simultaneous machining of multiple workpieces with complex shapes or five faces.



TTNC-102-2

Model		TTNC-102-2	TTNC-101-4	TTNC-151-2	TTNC-201-2
Tilt Range		-17° ~ +107°	-110° ~ +110°	-110° ~ +110°	-110° ~ +110°
Minimum table center distance		140	120	250	304.8
Spindle outer diameter		90h7	80h7	-	-
Table diameter (optional)		(135)	(115)	160	225
Table height at 0° position (w/ face plate)		230 (255)	275 (300)	270	350
Center height at 90° position		160	200	200	260
Center bore	Nose Diameter (w/ face plate)	55H7 (40H7)	50H7 (50H7)	35H7	40H7
	Thru Diameter	35	30	35	32
Table T-slot width (w/ face plate)		(12H8)	(10H8)	12H7	12H7
Guide block width		14h7	18h7	18h7	18h7
Servo motor (Fanuc)*	Rotary	Alpha 2i	Alpha 8i	Alpha 4i	Alpha 8i
	Tilt	Alpha 2i	Alpha 8i	Alpha 8i	Alpha 12i
Maximum motor speed		5,000	4,000	5,000	4,000
Speed reduction ratio		1/90	1/60	1/90	1/90
Maximum table speed		55.6	66.7	55.5	44.4
Inertia converted into motor shaft		.20	.52	.45	.48
Clamp system		Pneumatic	Pneumatic	Pneumatic	Hydraulic**
Clamp torque @72psi [500 psi]		127 (94)	80 (59)	78 (57)	[1,000] [(737)]
Indexing accuracy		±20	±30	±15	-
Tilting accuracy		-	±22.5	±30	-
Net Weight		100 (220)	370 (814)	340 (748)	550 (1,210)
Allowable wheel torque - rotary		93 (69)	176 (130)	147 (108)	470 (346)
Allowable work inertia		0.08	0.05	0.19	0.63
Allowable work weight	0° tilt angle	35 (77)	25 (55)	40 (88)	50 (110)
	0° ~ 90° tilt angle	20 (44)	25 (55)	40 (88)	50 (110)
Allowable work moment		54.8 (40.4)	176 (129.7)	156.8 (115.6)	254.8 (187.8)
Allowable load when table clamped		1,960 (439)	1,960 (439)	6,860 (1,537)	9,800 (2,195)
		127 (93.6)	80 (59)	78 (57.5)	490 (361)
		284 (209)	980 (722)	980 (722)	2,450 (1,806)

* Other motors & RPM available • ** Booster optional • Specifications subject to change without notice

Dimensions

Drawings not to scale • Dimensions = mm

TTNC-102-2

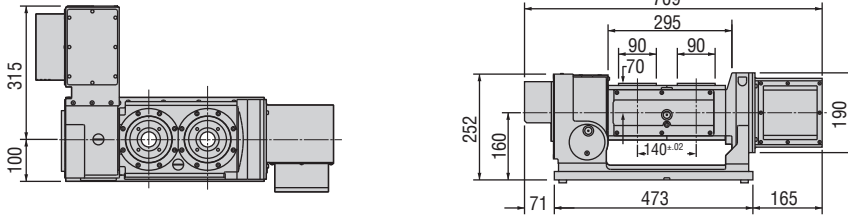

TTNC-101-4
5C Collet Option



TTNC-101-4

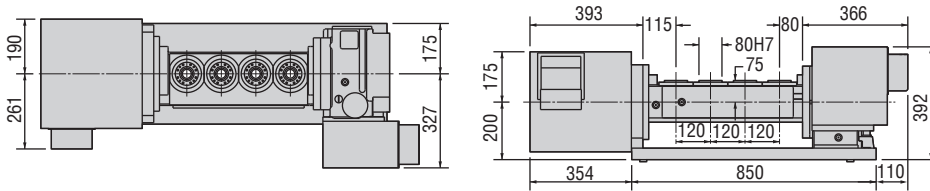

TTNC-151-2 RJ
Rotary Joint Option



TTNC-151-2

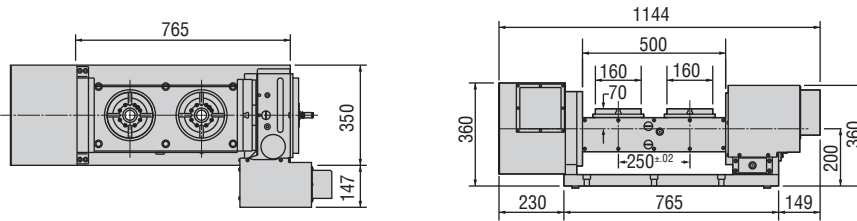

TTNC-201-2



TTNC-201-2

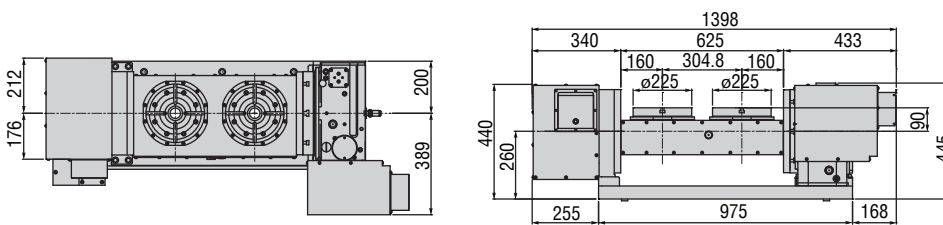

Options & Accessories

TPC NC Controller	p.68
Chucks	p.79
Tailstock	p.81
Support Spindle	p.81
Face Plate	p.83
Encoder / Scale	p.84
Pull Stud Device	p.85
Rotary Joint	p.85
PVC or Steel Cables	p.86

The dimensions above are for tables with a FANUC servo motor. Other motors available (dimensions may increase).

Layout a

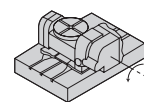

Layout b

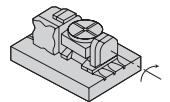

Clamping Block and Bolt

Dimensions = mm

	Type	Q'ty	Layout	T-Slot Width	A	B	C	D	E	F	G	H	I	J	K	L	M
TTNC-102-2	I	4	a b	14	20	12	70	10	35	25	20	17	8	55	35	23	12

Note 1: In the case of layout b, contact us for details about mounting.

Note 2: When using a machine with a T-slot pitch other than the above, use suitable clamping blocks and bolts that are available on the market, or order custom-made ones from KOMA (opt.)

Type I

