

# HARBOR

Bickimer Homes



5  
BEDS

4.5  
BATHS

3150  
SQ. FT.

**CENTURY  
FARMS**

2 STORY



UPPER LEVEL  
1,600 SQFT

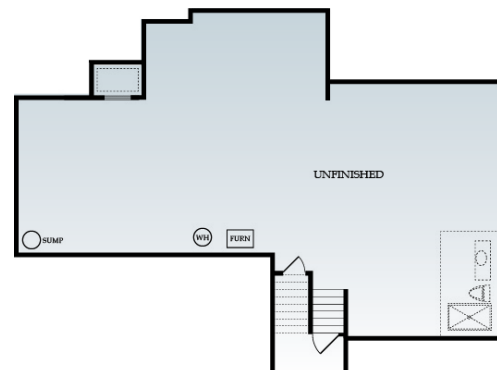

OPT. LOWER

1,550 SQFT  
MAIN LEVEL

Rachelle Moley (913) 433-4651  
Mike K. Perry P.C. (816) 210-4455

**CENTURYFARMSOP.COM**  
CenturyFarmsOP@gmail.com

**Weichert**  
REALTORS  
Welch & Company

**EXTERIOR:**

- Foundation: 9' Foundation Walls with Concrete Egress Window Well
- Roof: Limited Lifetime Warranty Roof
- Front: Stucco and Stone per Elevation with LP Smart Trim
- Sides and Rear: LP Smart Siding and Trim, 5/50 Limited Warranty
- Landscaping: Custom Design Allowance with Bluegrass Sod
- Doors: Insulated Garage Doors with Openers, Fiberglass Front Door
- Windows: Energy Efficient Low-E Windows
- Patio/Deck: Covered 12x16 Patio

**INTERIOR:****KITCHEN**

- o Choice of Knotty Alder, Birch or Paint Grade Cabinets
- o Cabinets include Full Extension Drawer Guides, Pull-out Trash Can, and Spice Rack
- o Level 1 Granite
- o Granite Center Island
- o Walk-in Pantry
- o Under Cabinet Lighting
- o Stainless Steel Appliance Package
- o Custom Mixed Width White Oak Hardwood Floors

**BATHS AND LAUNDRY**

- o Large Laundry Room Conveniently located by Master Suite
- o Tile Floor in Laundry and all Baths
- o Tile on all Shower and Tub Walls in Secondary Baths
- o Every Bedroom has its own Private Bathroom
- o Jetted Tub in Master Bath

**GREAT ROOM**

- o Direct Vent Fireplace
- o Custom Mixed Width White Oak Hardwood Floors

**ENERGY EFFICIENT FEATURES**

- o Engineered for Maximum Energy Efficiency
- o Independently Rated Resnet HERS Index Home
- o R-13 Wall Insulation with Grade 1 Verified Installation, R-49 Attic Insulation
- o 95% Lennox Furnace with Humidifier and 13 SEER AC
- o Energy Star Compliant Foam and Caulk Package

**OTHER FEATURES**

- o Built-In Boot Bench
- o First Floor Study
- o 8 Phone or Cable Outlets
- o 50 Gallon Water Heater and Ice Maker Water Line
- o Large Base and Casing throughout Main Floor
- o Flat Paint: 3 Wall Colors/1 Enamel/1 Stain
- o Stained Stair End Caps with Iron Spindles
- o Sump Pump
- o Bath Stub for future Basement Finish
- o Knockdown Ceilings Throughout (minus Garage)
- o Full Access to Design Center and Personal Decorator
- o In House Warranty Program

