

# TRUMAN

Bickimer Homes



4  
BEDS

3.5  
BATHS

2803  
SQ. FT.



1.5 STORY

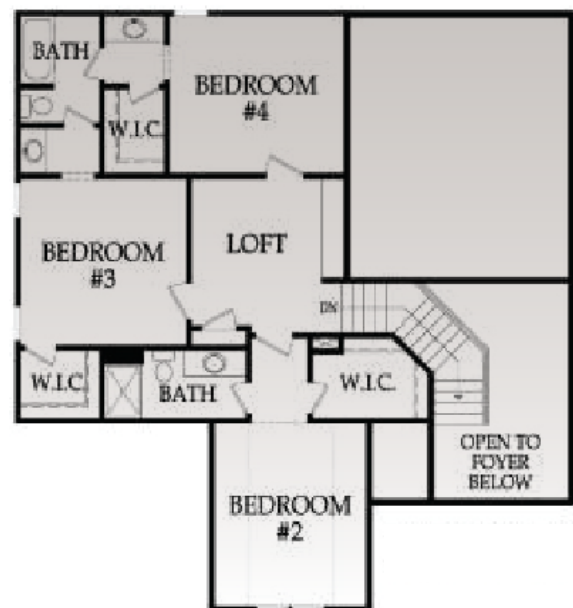

## EXTERIOR

- Foundation: 9' Foundation Walls with Concrete Egress Window Well
- Roof: Limited Lifetime Warranty Roof
- Front: Stucco and Stone per Elevation with LP Smart Trim
- Landscaping: Custom Design Allowance with Bluegrass Sod
- Doors: Insulated Garage Doors with Openers, Fiberglass Front Door
- Windows: Energy Efficient Low-E Windows
- Patio/Deck: Covered 17x14 Patio

## INTERIOR

### KITCHEN

- o Choice of Knotty Alder, Birch or Paint Grade Cabinets
- o Cabinets include Full Extension Drawer Guides, Pull-out Trash Can, and Spice Rack
- o Level 1 Granite
- o Granite Center Island
- o Walk-in Pantry
- o Under Cabinet Lighting
- o Stainless Steel Appliance Package
- o Custom Mixed Width or 4" White Oak Hardwood Floors

### BATHS & LAUNDRY

- o Large Laundry Room Conveniently located by Master Suite
- o Tile Floors in Laundry and all Baths
- o Cultured Marble Tops in all Baths
- o Tile on all Shower and Tub Walls in Secondary Baths
- o Every Bedroom has its own Separate Vanity
- o Jetted Tub in Master Bath

### GREAT ROOM

- o Custom Mixed Width or 4" White Oak Hardwood Floors
- o Direct Vent Fireplace

### ENERGY EFFICIENT FEATURES

- o Engineered for Maximum Energy Efficiency
- o Independently rated Resnet HERS Index Home
- o R-13 Wall Insulation with Grade 1 Verified Installation, R-49 Attic Insulation
- o 95 % Lennox Furnaces with Humidifier & 13 SEER AC
- o Energy Star Compliant Foam and Caulk Package

### OTHER FEATURES

- o True Mud Room with Built-in Boot Bench
- o Flex Room on Main Floor
- o 6 Phone or Cable Outlets
- o 50 Gallon Water Heater and Ice Maker Water Line
- o Large Base and Casing throughout Main Floor
- o Paint: 3 Wall Colors (flat)/1 Enamel/ 1 Stain
- o Sump Pump
- o Bonus Loft Space
- o Knockdown Ceilings Throughout (minus Garage)
- o Full Access to Design Center and Personal Decorator
- o In House Warranty Program

